



Available Soon

*artist rendering for illustration purposes and not actual home

1225 Vienna Drive, #724

Sunnyvale, California

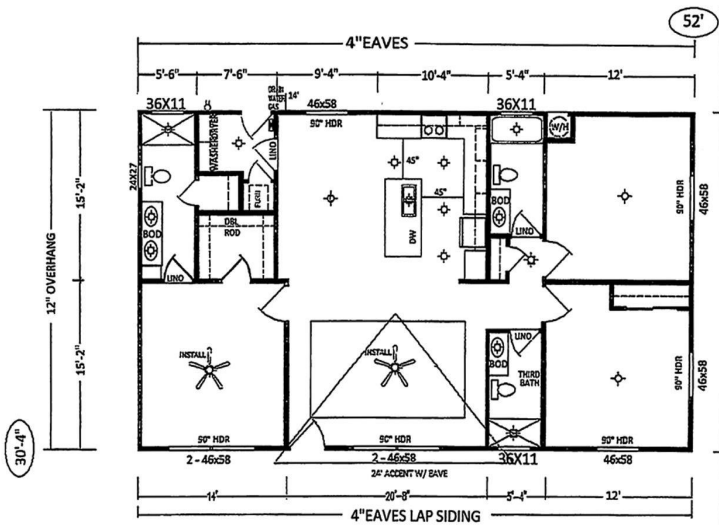

*For more information on this home, call our sales agent,
Sharon Prasad*

408-734-2746

If it's time to make a change, take a look at Plaza Del Rey, a well-maintained, professionally managed, manufactured home community. Right now, Plaza Del Rey is offering a 2022 model year, 2 bed/DEN/3 bath, 1580 sq. ft. home for only \$364,900.00 plus lot fees! A place of your own for less money than renting! Contact one of our representatives today to view this home and learn more about flexible financing and promotional incentives! NOTE: This home is still under construction completion date TBD Serial 237000HA001022A/B

Square Footage *	1580 Sq. Ft.
Bedrooms	2
Baths	3

Community Features:

- 2 Car Wash Stations
- 2 Laundry Rooms
- 2 Saunas
- 3 Billiard Rooms
- 3 Clubhouses with Kitchen
- 3 Libraries
- 3 Pools
- 3 Spas
- Bocceball Court

Serial 1 #: 237000HA001022A

Serial 2 #: 237000HA001022B

Enjoy Life at Its Best

www.HometownAmerica.com/PlazaDelRey

Square footage is approximate and may include covered porches.

